

Bridge-cut Aluminum Alloy Smart Door Lock

Manual

Please read this manual carefully before installation.
Please keep this manual in a safe place for future reference.

Table of Contents

1. Read before Use
2. Product Features
3. Technical Parameters
4. Installation Guide
5. Door Lock Settings
6. Product Warranty

Installation Instructions

Product pictures and display contents on the following pages are provided for reference only. Actual product features and specifications may vary. All specifications are subject to the actual product.

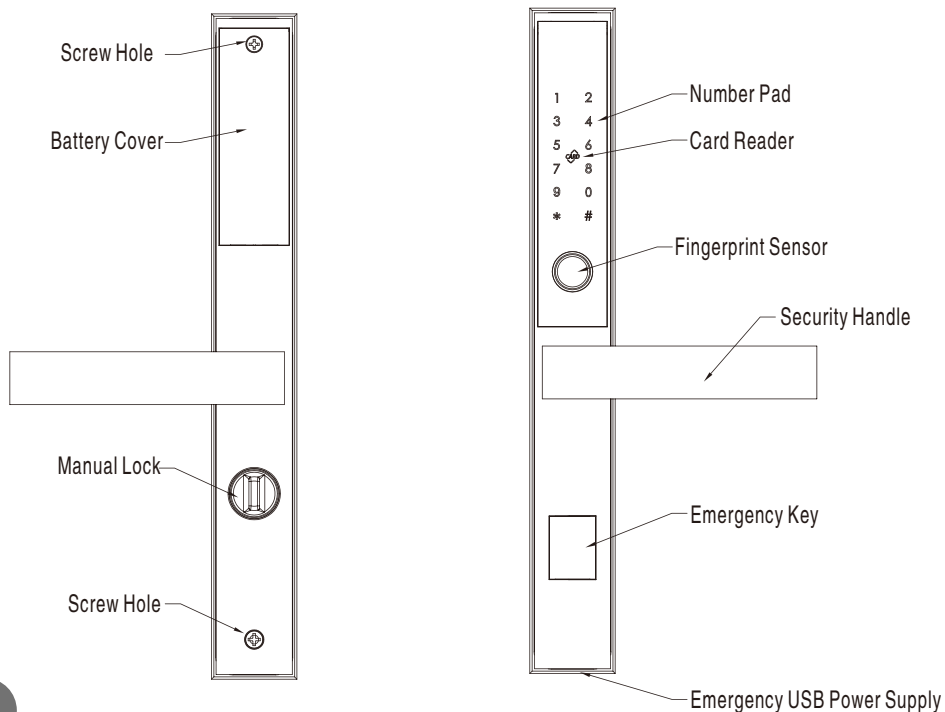

Read before Use

To use the smart lock product correctly, please read the manual carefully before installing and using the product for the first time.

For the actual specifications and configurations of the products, please consult with the seller.

If you did not follow the instructions, or let non-technical personnel of our company repair or change the product, we will not bear any responsibility for the damage caused thereby.

The graphs and charts provided in this manual are only for the purpose of explanation and illustration. There may be some differences from the actual product. In addition, the actual specifications and configuration of the product may be changed in real time as needed. All specifications and configuration are subject to the actual product.

The functions and design of this product can be changed without prior notice for quality improvement.

If you have any questions or ideas about our products during installation and use, or if you want to get the latest product information, please feel free to call our after-sales service department.

Product Features

In view of the security and modern management requirements of buildings, offices and residential communities, we have produced the smart digital door lock with fingerprint, card, password and key. Advanced fingerprint identification, non-contact swipe card and password are adopted as the key to open the door, and there are a variety of door opening modes to choose from, making it more flexible, convenient and safer!

- Fingerprints, cards, passwords and keys can be used to open the door.
- A variety of door opening modes can be selected to strengthen the safety level of the door lock.
- It has the function of preventing others from peeking at the password.
- POST, smart identification function module, quick matching function, such as fingerprint plus password or card plus password, etc.
- All components are made of high-quality raw materials, stable and reliable.
- Door lock modules are all treated with a certain degree of waterproof, moisture-proof and mildew-proof.
- Door lock modules are tested at certain high and low temperatures, vibration, aging, etc. to adapt to some harsh environments
- For special environments, check the actual situation first, and then judge whether it can be installed.

Technical Parameters

Power Supply	4.5 ~ 6.5 V(4 AAA–batteries)
Typical Quiescent Current	< 55 μ A (battery life can exceed one year)
Working Current	< 250 mA (strong driving capability)
Number of Fingerprints	≤ 100
Number of Cards	≤ 300
Number of Passwords	≤ 300
Number of Remote Controls	≤ 120
Resolution	500DPI
False Reject Rate	$\leq 0.15\%$
False Accept Rate	$\leq 0.00004\%$
Operating Temperature	-30°C ~ 60°C
Relative Humidity	20% ~ 93%

Installation Steps

The picture is for reference only

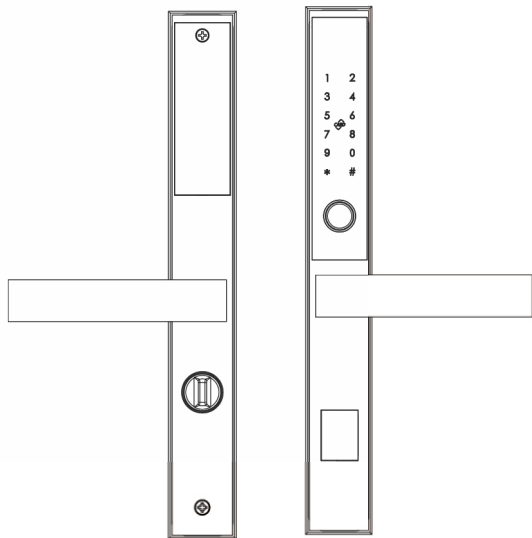

1

Installation Guide

2

Door Lock Structure

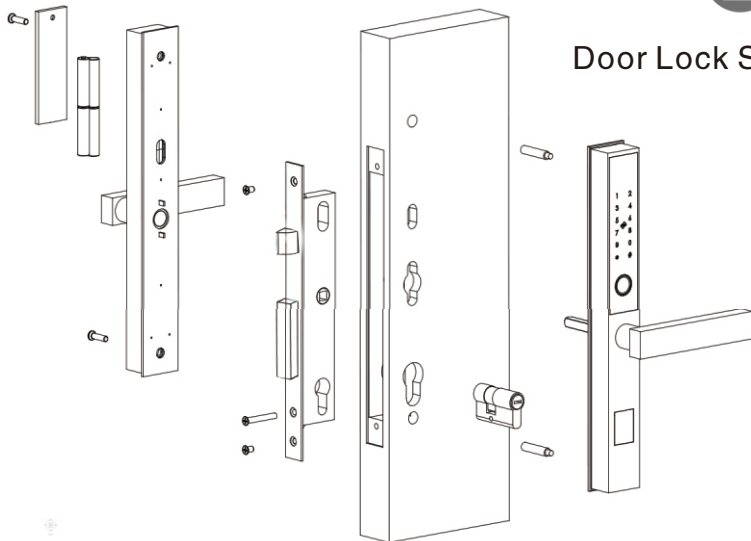

Installation Steps

The picture is for reference only

Install the Lock Body and Lock Cylinder

3

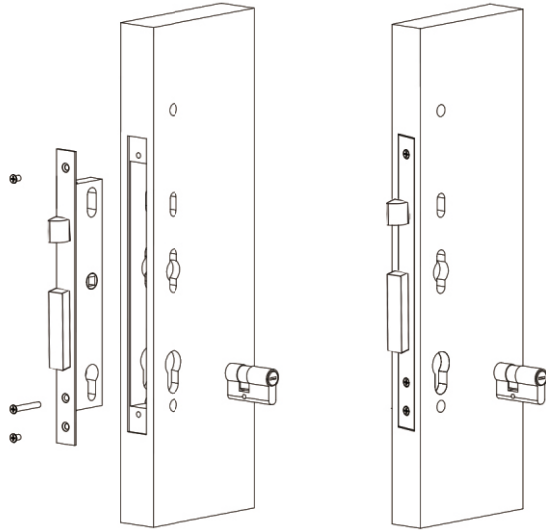

Install the Front Panel

4

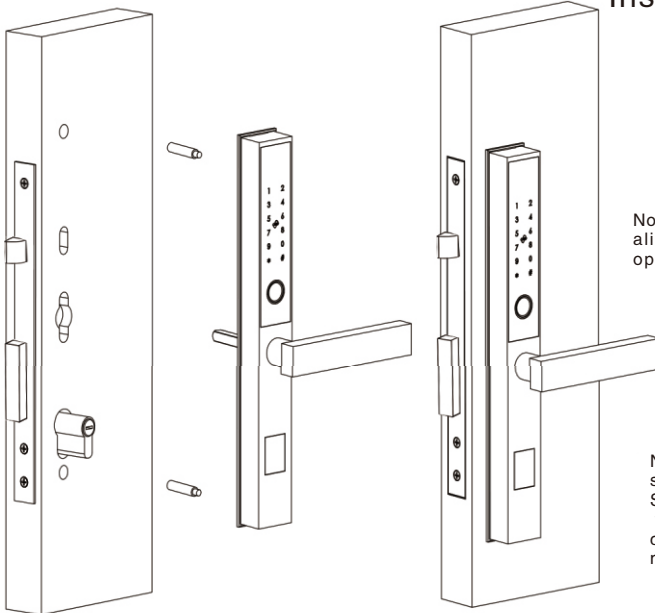

Note: The arrow mark must be aligned with the right or left open direction arrow marks.

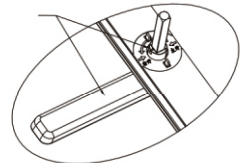

Note: Firstly, install the mating screw tube on the front panel. Second, install the front panel to the door (Connect the wire correctly. Do not misplace the matching holes)

7

Installation Steps

The picture is for reference only

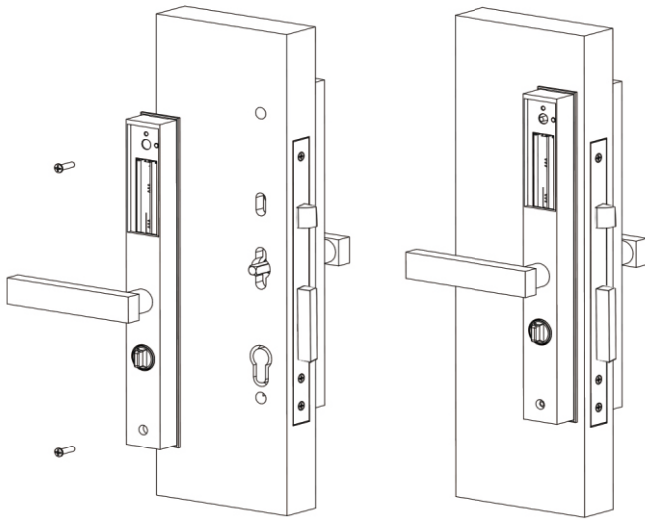

Install the Back Panel

5

Install the Batteries

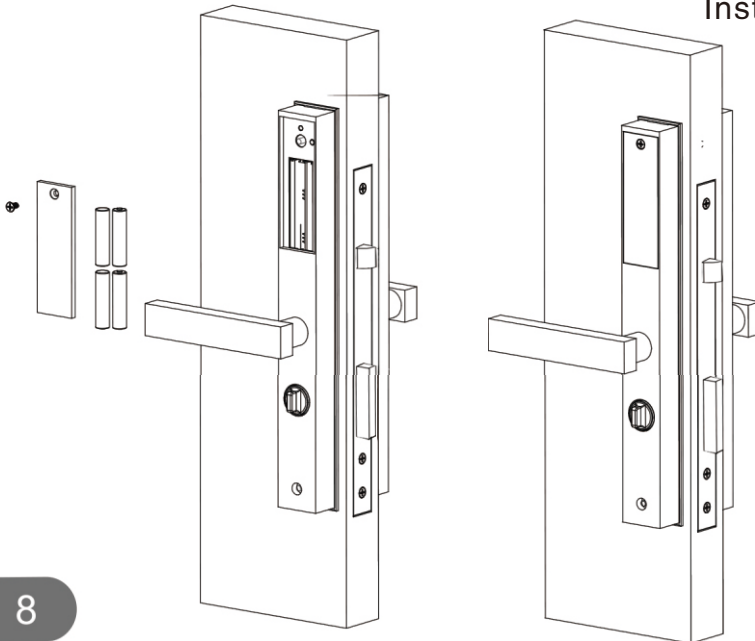

6

8

Installation Steps

The picture is for reference only

Installation is complete,
test the door lock

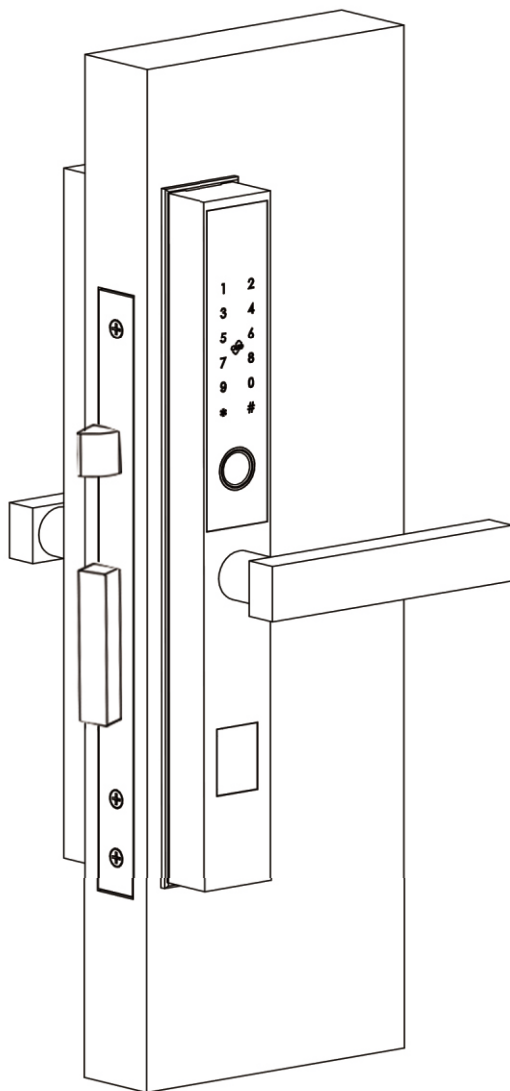

7

Product Settings

1. Initialization

Press the setting key (on the back panel) for 5 seconds, then voicebroadcast "initialization succeeded".

Note: The initial password is "123456", or any fingerprint can open the door. After setting the administrator information, the initial password will be deleted automatically.

2. Add Administrators Information (up to nine Administrators)

The "#" key is the Confirm Key or the Menu Function Key.

The "*" key is the Clear Key/Back Key.

In the initial state, touch the screen, press "*" and then press "#" buttons, or directly press the "Set" button on the back panel, then add the administrator information.

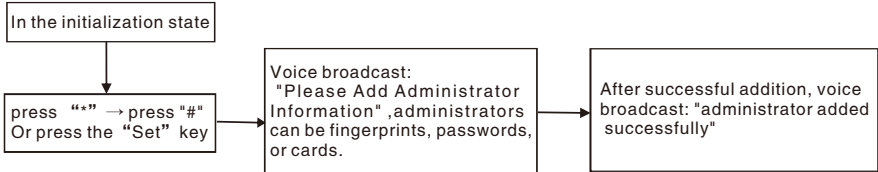

Note: Before adding the administrator information, you can use the initialized password (123456) to open the door.

After adding the admin information, the initial password will be automatically invalid.

3. Add Unlocking Information

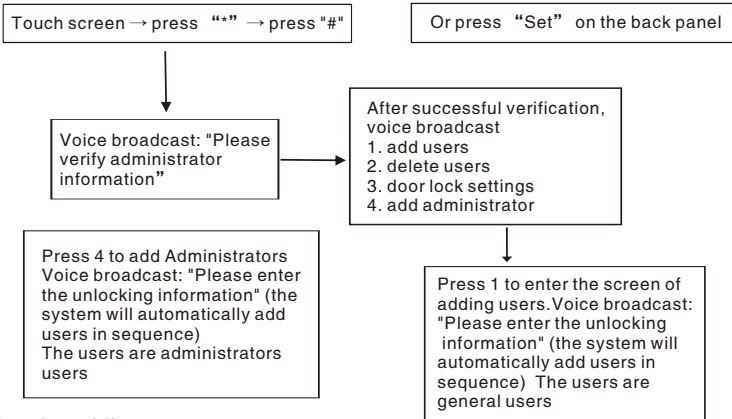

During the adding process, you can not add information that already exists
Password: 6 to 12 digits

Note:

The administrator user is recommended to set at least one group of fingerprint/password/card, and be sure to remember the administrator user information

Product Settings

Setup steps

4. Delete Unlocking Information

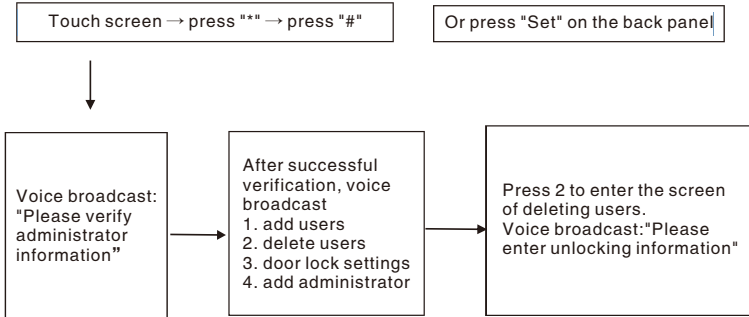

Note: To delete the user, fingerprint/card user must verify the unlocking information.

5. Normally Open Mode

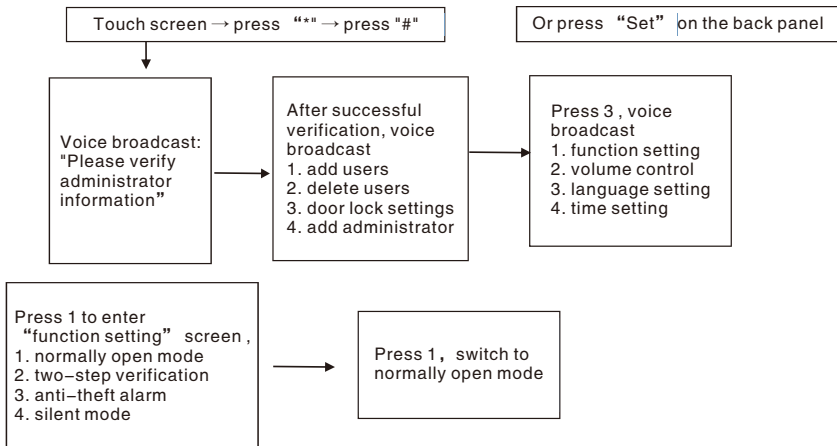

Note: After the normally open mode is turned on, each time when unlocking, the lock will enter the normally open state, press "*" to lock.

Product Settings

6.Silent Mode (Volume Control)

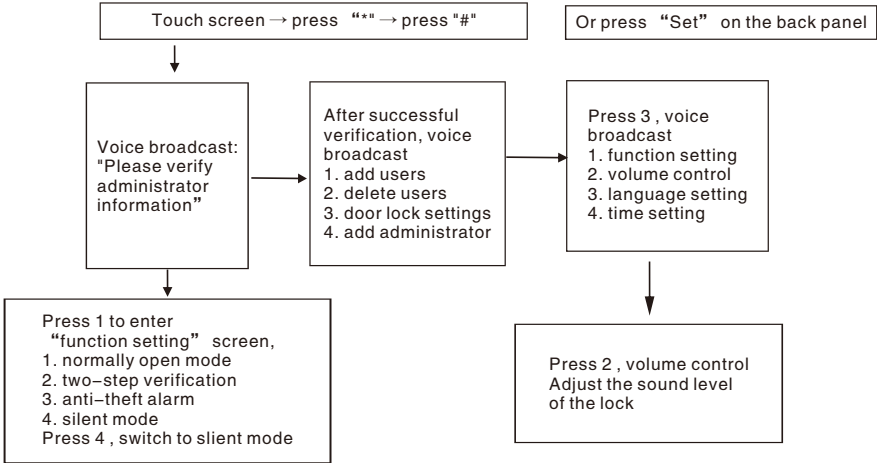

Note: After the mute mode is turned on, every time unlock will be mute.

7.Two-step Verification Mode

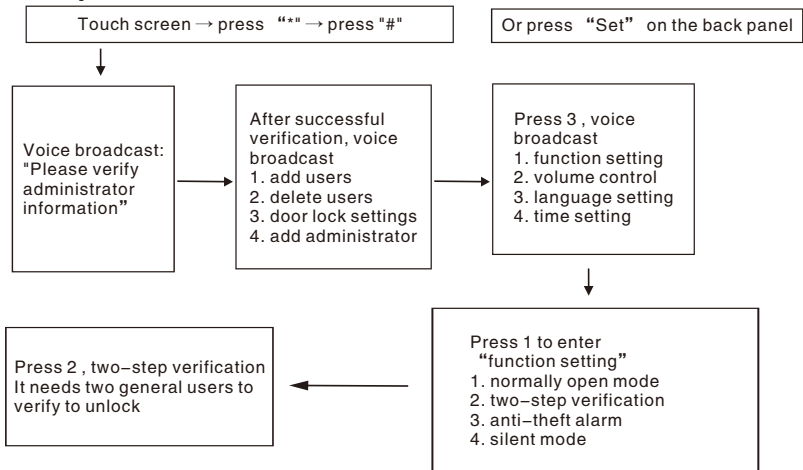

Note: Two-step verification is only for general users, and administrators are not restricted.

Product Settings

8. Language Setting

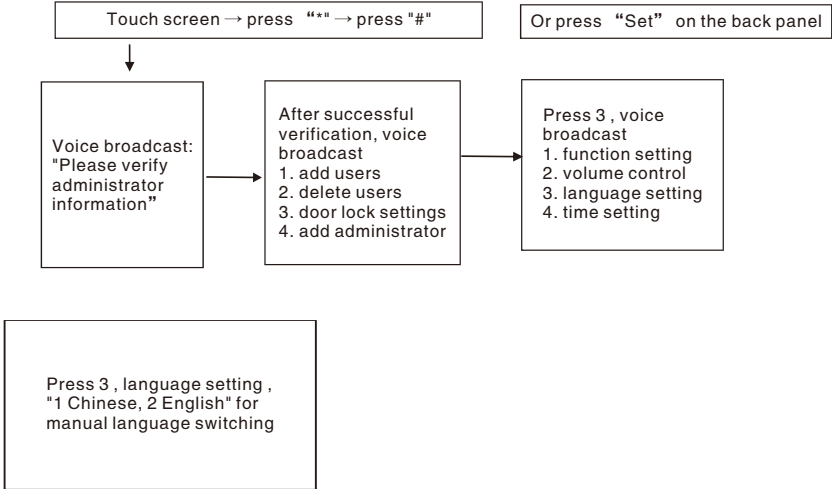

Note: When restoring the factory default settings, the original language remains unchanged, you need to enter the setting interface to switch language

9. Time Setting

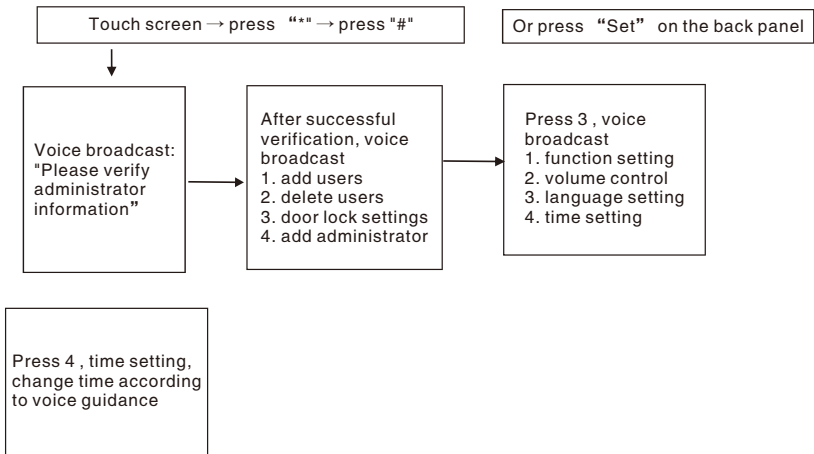

Product Settings

10. Other Instructions

- More than 5 times wrong password in 5 minutes, the keyboard will be locked for 90 seconds, the system will not respond to any operation within the 90 seconds, you can enter the administrator mode through the setting button on the back panel to remove restrictions.
- Password anti-peeking function: Enter the password as follows when opening the door: XXX password XXX. You can add some irrelevant digits before and after the password, and then press # to confirm. The password must be included.
- If there is no operation for more than 12 seconds, the system will automatically exit.
- Low Battery Alarm: When the voltage is lower than 4.8V, there will be an alarm when unlocking. Starting from the first alarm, the door lock can be unlocked for 200 times. Over this number, unlocking will be prohibited. Please replace the batteries in time after the low voltage alarm occurs.

Product Warranty

Dear Customers,

Thank you for using our products, a two-year warranty applies to our products unless otherwise specified at the time of purchase.

The following situations belong to after-sales warranty:

1. If the product has any quality problems within one month from the date of purchase, it will be replaced with a new one (both parties will bear half of the round-trip shipping cost).

2. If there is a quality problem during product using within one year, replace the related accessories according to the actual situation, the replacement technical guidance will be provided.

3. If there is a quality problem when the product has been used for more than one year but less than two years, replace related the accessories according to the actual situation (the costs incurred are charged according to the actual situation)

Note: The costs incurred during the after-sales maintenance of the warranty shall be negotiated and communicated according to the actual situation.

Under any of the following circumstances, it needs customers to pay for repairs:

- 1) Beyond the warranty period;
- 2) Product type on warranty card does not match the product itself;
- 3) Any product failure or damage caused by installation, usage, management and maintenance that are not in accordance with usage instructions;
- 4) Without getting the permission of our company, change its inherent structure or circuit privately, or dismantling or modifying without authorization;
- 5) Maintenance and installation in unauthorized places;
- 6) Product damage caused by accident, human abuse/misuse, immersion, smashing, etc.
- 7) Product failure or damages caused by force majeure such as earthquake, fire, flood lightning and so on.

Note: Do not put the spare key indoors! It is recommended to put it in another outdoor safe place for emergency unlocking.

